

roadscout[®]

RST1

Installation Guide



GPS innovations[™]
smarter fleet solutions

Getting Started

Before you begin the installation make sure you have all the following components to complete the install.

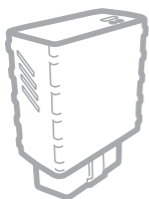

RoadScout
Device



IMEI Number
on the side of the box



NOTICE Sticker
for the windscreen

1. Locate the OBD-II port

The OBD-II port is usually located under the dashboard, beneath the steering wheel column (1- 3 in the diagram below).

Note: If not located beneath the steering column, look for the port in the areas indicated by numbers 4-6.

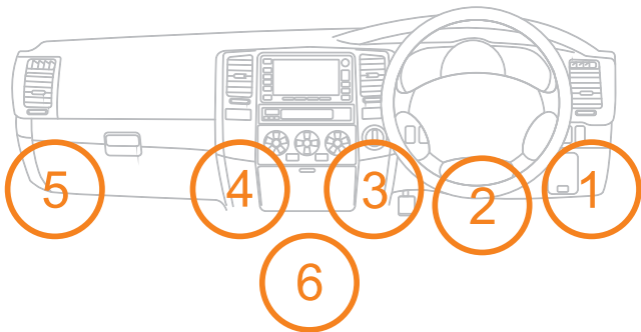

The OBD-II port is a 16 pin plug which is common in most late model vehicles and light trucks from 2006 onwards.

Need help?

1300 438 477
helpdesk@gpsi.com.au

2. Install directly into the OBD-II port

Choose a location where the vehicle is outdoors and NOT underground. eg. carpark or garage. In a single motion, push the RoadScout device firmly all the way into the OBD port. Wait until the GPS light flashes green.



IMPORTANT SAFETY NOTE

Ensure the device does not protrude out or interfere with the driver entering, exiting or operating the vehicle. If the device does interfere please call our help desk for alternative installation options.

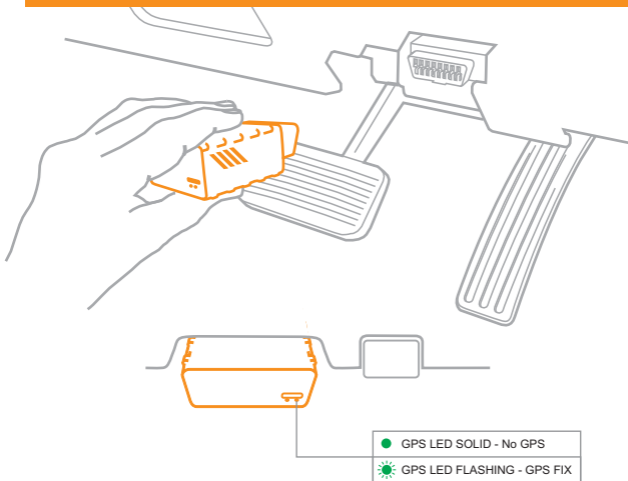

3. Start the vehicle



When the GPS light is flashing start the vehicle. Once the vehicle is running scan the Activation QR Code on the box or go to setup.gpsi.com.au using your mobile internet browser.

4. Device Activation



Enter the IMEI number found on the side of the box or on the device. If you see 4 orange ticks you have successfully installed the RoadScout device. Complete the install by adding the odometer reading and pressing Submit.

Well done!

You have successfully completed the install.

Apply the GPS Notice Sticker

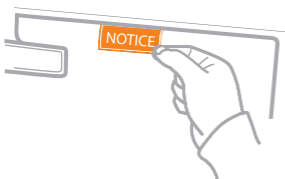

It is law that any vehicle being monitored must have a notice that is clearly in view of the driver. Place the sticker high on the inside corner of the windscreen.